



**35" CURVED 3440x1440 120Hz  
Gaming Monitor**

## **INSTRUCTION MANUAL**



**MODEL: DGVIEW220**



## Notices

Before using this product, please read this User Manual carefully and keep it well

---

- Keep the monitor away from water sources or damp places, such as bath rooms, kitchens, basements and swimming pools.
- Make sure the monitor is placed on a flat surface. If the monitor falls down, it may cause human injury or device damage.
- Store and use the monitor in a cool, dry and well ventilated place, and keep it away from emission and heat sources.
- Do not cover or block the vent hole in the rear casing, and do not use the product on a bed, sofa, blanket or similar objects.
- The range of the supply voltage of the monitor is printed on the label on the rear casing. It is impossible to determine the supply voltage, please consult the distributor or local power company.
- If the monitor will not be used for a long period, please cut off the power supply to avoid electric shock in rainy days and damage due to abnormal supply voltage.
- Please use a reliable earthing socket, do not overload the socket, or it may cause fire or electric shock.
- Do not put foreign matters into the monitor, or it may cause short circuits resulting in fire or electric shock.
- Do not disassemble or repair this product by self to avoid electric shock. If faults occur, please contact the after-sales service directly.
- Do not pull or twist the power cable forcibly.
- There is a polarizer layer (not a protective film) on the surface of the screen. Do not peel it off, or the product may be damaged and the warranty will be invalid.

## Product introduction

### Packing list

- Please check that the package of the monitor contains all parts. If any part is lost, please contact the distributor.
- The color and shape of parts may vary with models. Figures in this User Manual are for reference only.
- Wires supplied may vary with purchased products. Figures in this User Manual are for reference only.



LED Monitor



Stand



Base



Rotary Shaft Component



① Screws x 3



② Screws x 2



③ Mount Screws x 4

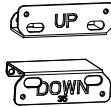

Mount adapter

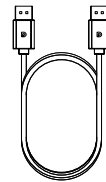

DP Cable

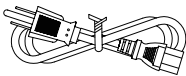

Power Cable



User Manual



## Installation

### Installation of base

1. Open the carton package, take out the upper and lower foam covers and put them flat on the table top.

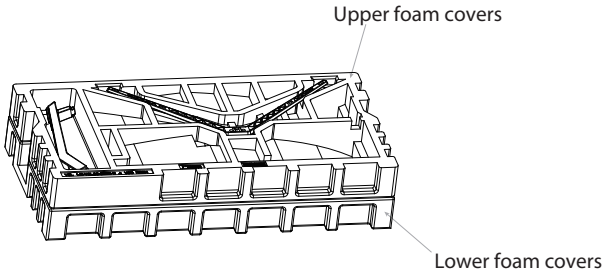

2. Remove the upper styrofoam and the inner bag protection bag, and place the lower styrofoam on the desktop, and the machine should not leave the lower styrofoam.

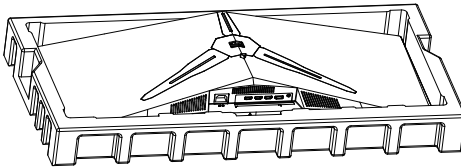

3. Tighten the bracket and base together with a screw lock as shown in the figure below.

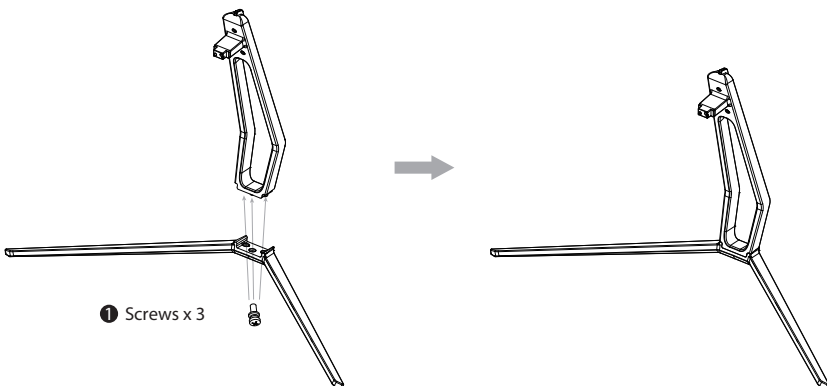

4. Press the quick release button to take out the rotary shaft component.

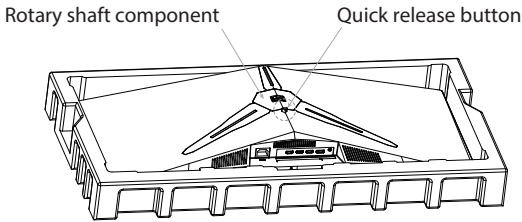

5. Assemble the rotary shaft component to the bracket as shown in the figure and lock it with the accessory screws, Buckle the installed base back to its original position. (Pay attention to check: whether there is any looseness.)

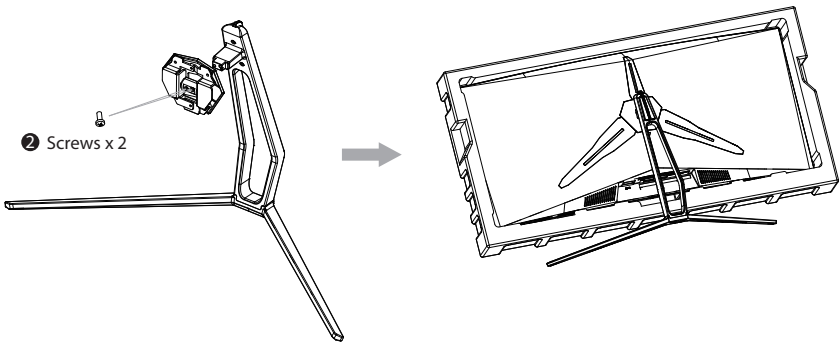

6. Simply hold the stand with hand to stand the monitor upright.

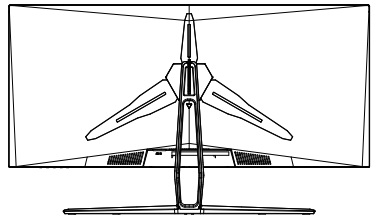
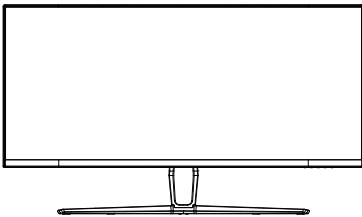

Note: During standing of the whole monitor, do not press the liquid crystal screen with hand to avoid damage to the screen.

## Installation of mount

1. Open the carton package, take out the upper and lower foam covers and put them flat on the table top.

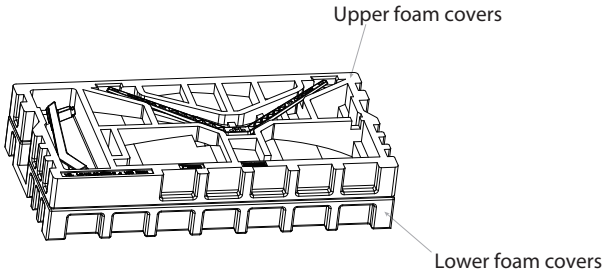

2. Remove the upper styrofoam and the inner bag protection bag, and place the lower styrofoam on the desktop, and the machine should not leave the lower styrofoam. then Press the quick release button to take out the rotary shaft component.

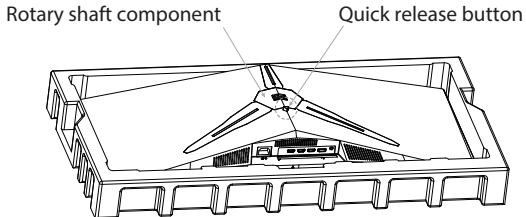

3. Remove the four screws securing the rear case.

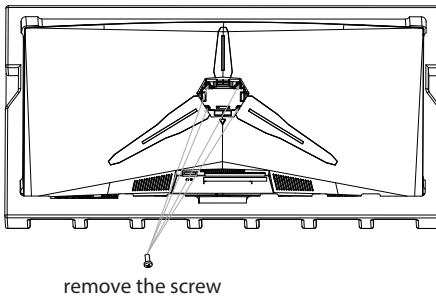

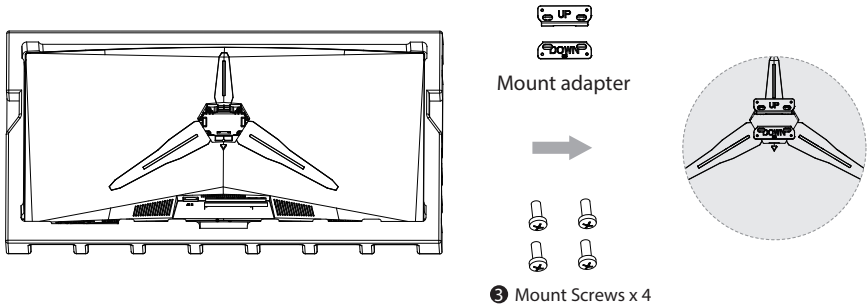

4. Take out the wall mount adapter and tighten the locking screw.

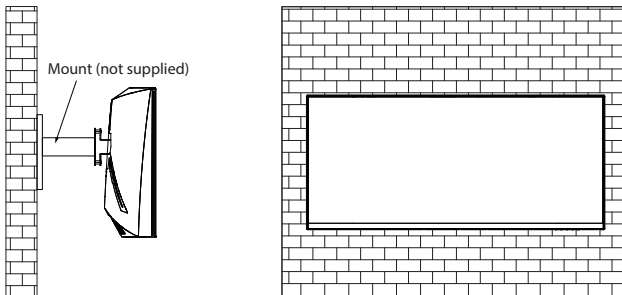

5. During padlocking of the monitor, do not pinch the screen with the hands to avoid damaging the screen. Install the mount to the mount stud by referring to the user manual of the mount (purchased separately).

Tips: The mounting hole distance of the mount for the product is 75x75mm.



 Notes: To prevent the monitor on the mount from failing, please install it firmly and protect it fully. Do not place or hang any object on the mount, and the using height of the mount should be less than 2 meters.

Adjusting the monitor

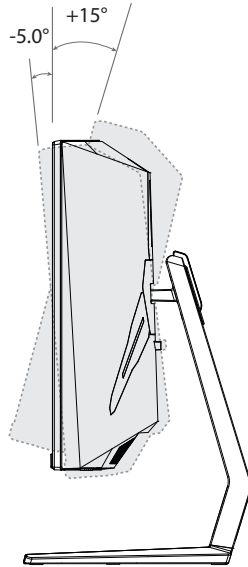

Tilting angle  
 $-5.0^{\circ}(\pm 2.0^{\circ}) - +15^{\circ}(\pm 2.0^{\circ})$

## Usage

### Description of buttons

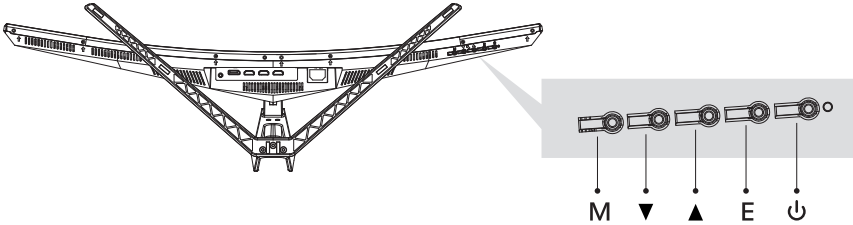

| Button | Function   |
|--------|--|
| 1      | <b>M</b> Menu button: Press to enter sub-menus/ quickly enter the main menu.                 |
| 2      | <b>▼</b> Down button: Press to move down in the menu/quickly enter the game crosshair mode.  |
| 3      | <b>▲</b> Up button: Press to move up in the menu/quickly enter the contextual mode.          |
| 4      | <b>E</b> Exit/hot key: Press to return to the previous menu/quickly switch the color format. |
| 5      | <b>⏻</b> Power button: Press to turn on/off the monitor.                                     |

### Explanation of indicators

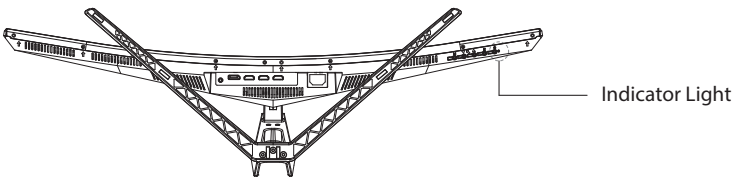

Indicator light: Solid blue light indicates power is on and the monitor is operating normally. Flashing blue light indicates no video source has been detected. Please ensure your computer is on and all video cables are fully inserted and or Connected.

## Cable connection

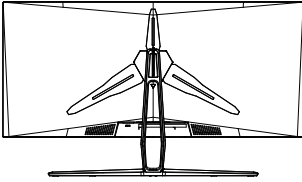

\*The bottom interface configuration at the back of the monitor varies with products.

\*Note: If the power cable or signal cable is damaged, you must replace it with special soft cables or special components purchased from the manufacture or maintenance department.

### HDMI interface

Use the HDMI cable to connect the HDMI IN interface of the product to the HDMI OUT interface of a PC.

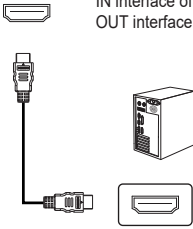

Use the HDMI-DVI cable (not included) to connect the HDMI IN port of the product to the DVI OUT port of a PC. (In general, PCs do not transfer video signals to the monitor through the DVI OUT interface, and it is necessary to connect a loudspeaker box additionally to play sounds of PCs.)

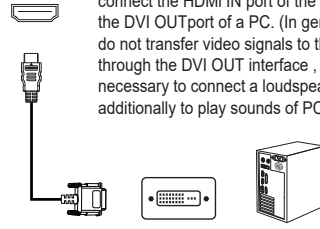

### DP interface

Use the DP cable to connect the DP IN port of the product to the DP OUT port of a PC.

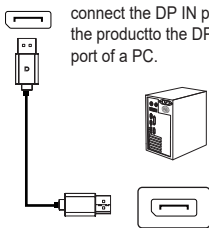

### AUDIO OUT

Connect audio outputting devices such as earphones to the Audio out interface.

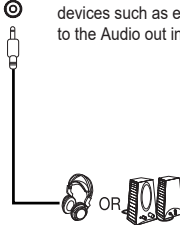

### AC IN interface

Please connect the power cable plug to the corresponding port of the monitor, and connect the other end to a properly grounded power outlet.

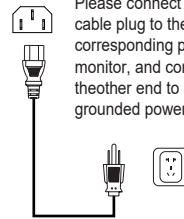

## OSD menu

### Menu description

- The color and shape of the OSD menu of the actual computer may be slightly different from them shown in the figure.
- Specifications of the OSD menu may change with improvements of functions without prior notice.

The on-screen display (OSD) menu can be used to adjust the settings of the monitor and is displayed on the screen after turning on the monitor and pressing the button.

1. Press any one of the buttons (M, , , E, ) to activate the navigation window.

|   |                                 |
|---|---------------------------------|
| 1 | Confirm and enter the main menu |
| 2 | Game sight                      |
| 3 | Contextual mode                 |
| 4 | Color format                    |
| 5 | Power ON/OFF                    |

2. Press to enter the OSD screen.

3. Press or to browse through the functions.

-Select the desired function, then press the button to enter the submenu.

-Press or to browse the sub-menus, and then press the key to confirm the selection of the desired function.

-Press or to select an option, then press to confirm the setting and exit the current menu.

4. Press to exit the menu interface.



• Functions of the monitor vary with models, and the functions in this manual are for reference only.

|                            |                          |   |
|----------------------------|--------------------------|---|
| Input Source               | DP1                      | N/A   |
|                            | DP2                      | N/A   |
|                            | HDMI1                    | N/A   |
|                            | HDMI2                    | N/A   |
| Brightness/<br>Contrast    | Brightness               | 0-100   |
|                            | Blacklevel               | 0-100   |
|                            | Contrast                 | 0-100   |
|                            | DCR                      | On/Off  |
| Color Setting              | Gamma                    | 1.8/2.0/2.2/2.4/2.6                           |
|                            | Picture Mode             | Standard/Photo/Movie/Game/FPS/RTS             |
|                            | Color Temperature        | Warm/Cool/USER                                |
|                            | Low Blue Light           | 0-100   |
|                            | Hue                      | 0-100   |
| Picture Quality<br>Setting | Saturation               | 0-100   |
|                            | Sharpness                | 0-100   |
|                            | Response Time            | Off/High/Middle/Low                           |
|                            | Noise Reduction          | Off/High/Middle/Low                           |
|                            | Super Resolution         | Off/High/Middle/Low                           |
| Display                    | Dynamic Luminous Control | On/Off  |
|                            | Aspect Ratio             | Wide Screen/4:3/1:1/Auto                      |
| Audio                      | LedMode                  | Normal /Off/Flicker                           |
|                            | Mute                     | On/Off  |
|                            | Volume                   | 0-100   |
| Multi-Window               | Audio Source             | HDMI1/HDMI2/DP1/DP2                           |
|                            | Multi-Window             | Off/PIP Mode/PBP 2Win                         |
|                            | Sub Win2 Input           | DP1/DP2/HDMI1/HDMI2                           |
|                            | PIP Size                 | Small/Medium/Large                            |
|                            | PIP Position             | TopRight/Topleft/BottomRight/Bottomleft       |
| OSD                        | Swap                     | N/A   |
|                            | Language                 | English/简体中文/한국어/РУССКИЙ/Español/日本語/Francais |
|                            | OSD H-Position           | 0-100   |
|                            | OSD V-Position           | 0-100   |
|                            | OSD Transparency         | 0-100   |
|                            | OSD Time Out             | 5-100   |
| Other                      | OSD Rotation             | Normal/90/180/270                             |
|                            | DP Version               | DP1.1/DP1.2/DP1.4                             |
|                            | Adaptive-Sync            | On/Off  |
|                            | HDR                      | On/Off/Auto Detect                            |
|                            | Reset                    | N/A   |

## Specification

|                                    |   |  |
|------------------------------------|---|--|
| Product Name                       | Liquid Crystal Display                                |  |
| Product model                      | DGVIEW220   |  |
| Screen Size                        | 35" (89cm)  |  |
| Aspect Ratio                       | 21:9  |  |
| Viewing Angle                      | 178°(H) / 178°(V)                                     |  |
| Pixel pitch                        | 0.2382 (H) x 0.2402 (V) mm                            |  |
| Contrast ratio                     | 3000:1 (TYP)  |  |
| Colors                             | 16.7M   |  |
| Resolution                         | 3440 x 1440   |  |
| Maximum refresh rate               | 120Hz   |  |
| Power Input                        | 100-240V~, 50/60Hz, 2.0A                              |  |
| Product Dimensions<br>Lifting base | Without base  | 837.4 x 377.9 x 122.6 mm   |
|                                    | With base   | 837.4 x 484.9 x 245.1 mm   |
| Tilting angle                      | Forward tilting : 5° ± 2°; Backward tilting: 15° ± 2° |  |
| Net Weight                         | 7.4 kg  |  |
| Gross Weight                       | 10.1 kg   |  |
| Height range                       | N/A   |  |
| Rotation angle                     | N/A   |  |
| Vertical angle                     | N/A   |  |
| speaker                            | N/A   |  |
| Environmental conditions           | Action  | Temperature: 0°C~ 40°C (32°F ~ 104°F)<br>Humidity: 10%~90% RH (non-condensing) |
|                                    | Storage   | Temperature: -20°~ 60° (-4°F ~ 140°F)<br>Humidity: 5%~95% RH (non-condensing)  |



The terms HDMI and HDMI High-Definition Multimedia Interface, and the HDMI Logo are trademarks or registered trademarks of HDMI Licensing Administrator, Inc. in the United States and other countries.



This device complies with part 15 of the FCC Rules. Operation is subject to the following two conditions: (1) This device may not cause harmful interference, and (2) this device must accept any interference received, including interference that may cause undesired operation.

## Supported resolution and refresh rate

| HDMI1[2.0]                           |
|--------------------------------------|
| Detailed Timing                      |
| 3440x1440@60Hz                       |
| 3440x1440@50Hz                       |
| 3440x1440@100Hz                      |
| 1720x1440@60Hz                       |
| 2560x1440@120Hz                      |
| Established Timing                   |
| 720x400@70Hz-IBM.VGA                 |
| 640x480@60Hz-IBM.VGA                 |
| 640x480@75Hz-VESA                    |
| 800x600@60Hz-VESA                    |
| 800x600@75Hz-VESA                    |
| 1024x768@60Hz-VESA                   |
| 1024x768@75Hz-VESA                   |
| 1280x1024@75Hz-VESA                  |
| Standard Timing                      |
| 1152x864@75Hz-VESASTD                |
| 1280x720@60Hz-VESASTD                |
| 1280x960@60Hz-VESASTD                |
| 1280x1024@60Hz-VESASTD               |
| 1400x900@60Hz-VESASTD                |
| 1600x900@60Hz-VESASTD                |
| 1680x1050@60Hz-VESASTD               |
| 1920x1080@60Hz-VESASTD               |
| Video Timing                         |
| [1]640x480p@59.94Hz@4:3@1:1          |
| [2]720x480p@59.94Hz/60Hz@4:3@8:9     |
| [3]720x480p@59.94Hz/60Hz@16:9@32:27  |
| [4]1280x720p@59.94Hz/60Hz@16:9@1:1   |
| [5]1920x1080i@59.94Hz/60Hz@16:9@1:1  |
| [16]1920x1080p@59.94Hz/60Hz@16:9@1:1 |
| [17]720x576p@50Hz@4:3@16:15          |
| [18]720x576p@50Hz@16:9@64:45         |
| [19]1280x720p@50Hz@16:9@1:1          |
| [20]1920x1080i@50Hz@16:9@1:1         |
| [31]1920x1080p@50Hz@16:9@1:1         |
| [63]1920x1080p@119.88/120Hz@16:9@1:1 |

| HDMI2[2.0]                           |
|--------------------------------------|
| Detailed Timing                      |
| 3440x1440@60Hz                       |
| 3440x1440@50Hz                       |
| 3440x1440@100Hz                      |
| 1720x1440@60Hz                       |
| 2560x1440@120Hz                      |
| Established Timing                   |
| 720x400@70Hz-IBM.VGA                 |
| 640x480@60Hz-IBM.VGA                 |
| 640x480@75Hz-VESA                    |
| 800x600@60Hz-VESA                    |
| 800x600@75Hz-VESA                    |
| 1024x768@60Hz-VESA                   |
| 1024x768@75Hz-VESA                   |
| 1280x1024@75Hz-VESA                  |
| Standard Timing                      |
| 1152x864@75Hz-VESASTD                |
| 1280x720@60Hz-VESASTD                |
| 1280x960@60Hz-VESASTD                |
| 1280x1024@60Hz-VESASTD               |
| 1400x900@60Hz-VESASTD                |
| 1600x900@60Hz-VESASTD                |
| 1680x1050@60Hz-VESASTD               |
| 1920x1080@60Hz-VESASTD               |
| Video Timing                         |
| [1]640x480p@59.94Hz@4:3@1:1          |
| [2]720x480p@59.94Hz/60Hz@4:3@8:9     |
| [3]720x480p@59.94Hz/60Hz@16:9@32:27  |
| [4]1280x720p@59.94Hz/60Hz@16:9@1:1   |
| [5]1920x1080i@59.94Hz/60Hz@16:9@1:1  |
| [16]1920x1080p@59.94Hz/60Hz@16:9@1:1 |
| [17]720x576p@50Hz@4:3@16:15          |
| [18]720x576p@50Hz@16:9@64:45         |
| [19]1280x720p@50Hz@16:9@1:1          |
| [20]1920x1080i@50Hz@16:9@1:1         |
| [31]1920x1080p@50Hz@16:9@1:1         |
| [63]1920x1080p@119.88/120Hz@16:9@1:1 |

| DP1[1.4]                             |
|--------------------------------------|
| <b>Detailed Timing</b>               |
| 3440x1440@60Hz                       |
| 3440x1440@120Hz                      |
| 3440x1440@50Hz                       |
| 2560x1440@120Hz                      |
| 3440x1440@100Hz                      |
| 1720x1440@60Hz                       |
| <b>Established Timing</b>            |
| 720x400@70Hz-IBM.VGA                 |
| 640x480@60Hz-IBM.VGA                 |
| 640x480@75Hz-VESA                    |
| 800x600@60Hz-VESA                    |
| 800x600@75Hz-VESA                    |
| 1024x768@60Hz-VESA                   |
| 1024x768@75Hz-VESA                   |
| 1280x1024@75Hz-VESA                  |
| <b>Standard Timing</b>               |
| 1152x648@75Hz-VESASTD                |
| 1280x720@60Hz-VESASTD                |
| 1280x960@60Hz-VESASTD                |
| 1280x1024@60Hz-VESASTD               |
| 1400x900@61Hz-VESASTD                |
| 1600x900@60Hz-VESASTD                |
| 1680x1050@60Hz-VESASTD               |
| 1920x1080@60Hz-VESASTD               |
| <b>Video Timing</b>                  |
| [1]640x480p@59.94Hz@4:3@1:1          |
| [2]720x480p@59.94Hz/60Hz@4:3@8:9     |
| [3]720x480p@59.94Hz/60Hz@16:9@32:27  |
| [4]1280x720p@59.94Hz/60Hz@16:9@1:1   |
| [5]1920x1080i@59.94Hz/60Hz@16:9@1:1  |
| [16]1920x1080p@59.94Hz/60Hz@16:9@1:1 |
| [17]720x576p@50Hz@4:3@16:15          |
| [18]720x576p@50Hz@16:9@64:45         |
| [19]1280x720p@50Hz@16:9@1:1          |
| [20]1920x1080i@50Hz@16:9@1:1         |
| [31]1920x1080p@50Hz@16:9@1:1         |
| [32]1920x1080p@23.98Hz/24Hz@16:9@1:1 |
| [34]1920x1080p@29.97Hz/30Hz@16:9@1:1 |
| [63]1920x1080p@119.88/120Hz@16:9@1:1 |

| DP2[1.4]                             |
|--------------------------------------|
| <b>Detailed Timing</b>               |
| 3440x1440@60Hz                       |
| 3440x1440@120Hz                      |
| 3440x1440@50Hz                       |
| 2560x1440@120Hz                      |
| 3440x1440@100Hz                      |
| 1720x1440@60Hz                       |
| <b>Established Timing</b>            |
| 720x400@70Hz-IBM.VGA                 |
| 640x480@60Hz-IBM.VGA                 |
| 640x480@75Hz-VESA                    |
| 800x600@60Hz-VESA                    |
| 800x600@75Hz-VESA                    |
| 1024x768@60Hz-VESA                   |
| 1024x768@75Hz-VESA                   |
| 1280x1024@75Hz-VESA                  |
| <b>Standard Timing</b>               |
| 1152x648@75Hz-VESASTD                |
| 1280x720@60Hz-VESASTD                |
| 1280x960@60Hz-VESASTD                |
| 1280x1024@60Hz-VESASTD               |
| 1400x900@61Hz-VESASTD                |
| 1600x900@60Hz-VESASTD                |
| 1680x1050@60Hz-VESASTD               |
| 1920x1080@60Hz-VESASTD               |
| <b>Video Timing</b>                  |
| [1]640x480p@59.94Hz@4:3@1:1          |
| [2]720x480p@59.94Hz/60Hz@4:3@8:9     |
| [3]720x480p@59.94Hz/60Hz@16:9@32:27  |
| [4]1280x720p@59.94Hz/60Hz@16:9@1:1   |
| [5]1920x1080i@59.94Hz/60Hz@16:9@1:1  |
| [16]1920x1080p@59.94Hz/60Hz@16:9@1:1 |
| [17]720x576p@50Hz@4:3@16:15          |
| [18]720x576p@50Hz@16:9@64:45         |
| [19]1280x720p@50Hz@16:9@1:1          |
| [20]1920x1080i@50Hz@16:9@1:1         |
| [31]1920x1080p@50Hz@16:9@1:1         |
| [32]1920x1080p@23.98Hz/24Hz@16:9@1:1 |
| [34]1920x1080p@29.97Hz/30Hz@16:9@1:1 |
| [63]1920x1080p@119.88/120Hz@16:9@1:1 |

## **Manufacturer's 1-Year Limited Warranty**

---

The manufacturer warrants that all parts and components are defect free in materials and workmanship for 1 year. This warranty is valid only in accordance with the conditions set forth below:

1. The warranty extends only to the original consumer purchaser and is not transferable. In addition, proof of purchase must be demonstrated.
2. This limited warranty is the only written or express warranty given by the manufacturer. Any implied warranty of merchantability or fitness for a particular purpose on this product is limited in duration to the duration of this warranty. Some states do not allow limitations on how long an implied warranty lasts, so the above limitation may not apply to you.
3. This warranty gives you specific legal rights. You may also have other rights which vary by state.

## **Procedure for Replacement or Return within the 1 Year:**

---

To return the product for replacement or refund within the 1 year, the original purchaser must pack the product securely and send it postage paid with a description of the reason for replacement or refund, proof of purchase, and include your order number on the package, to the following address:

Deco Gear  
80 Carter Drive  
Edison, NJ 08817

### **Other contact info**

Phone: 844-413-2646  
Customer Service Email: [customerservice@decogear.com](mailto:customerservice@decogear.com)



**dec**  **gear**®

|      |                          |      |            |
|------|--------------------------|------|------------|
| 物料号码 | 108.007.xxxxx            |      |            |
| 厂内型号 | V3G6W                    | 厂外型号 | DGVIEW220  |
| 物料名称 | 说明书                      | 品 牌  | DECO GEAR  |
| 协力厂商 |                          | 日 期  | 2022-05-30 |
| 规 格  | 140x210mm                |      |            |
| 要 求  | 120G铜版纸，封面封底过光膜，彩色印刷，骑马钉 |      |            |
| 版 本  | V01                      | 设 计  | 唐喜阳        |
| 确 认  |                          | 核 准  |            |

备注:如不够页数，可以在封面封底的内面插入空白页.