

DECOGEAR[®]

40" CURVED ULTRAWIDE MONITOR



DGVIEW401

- Keep the monitor away from water sources or damp places, such as bath rooms, kitchens, basements and swimming pools.
- Make sure the monitor is placed on a flat surface. If the monitor falls down, it may cause human injury or device damage.
- Store and use the monitor in a cool, dry and well ventilated place, and keep it away from emission and heat sources.
- Do not cover or block the vent hole in the rear casing, and do not use the product on a bed, sofa, blanket or similar objects.
- The range of the supply voltage of the monitor is printed on the label on the rear casing. If it is impossible to determine the supply voltage, please consult the distributor or local power company.
- If the monitor will not be used for a long period, please cut off the power supply to avoid electric shock in rainy days and damage due to abnormal supply voltage.
- Please use a reliable earthing socket, do not overload the socket, or it may cause fire or electric shock.
- Do not put foreign matters into the monitor, or it may cause short circuits resulting fire or electric shock.
- Do not disassemble or repair this product by self to avoid electric shock. If faults occur, please contact the after-sales service directly.
- Do not pull or twist the power cable forcedly.
- There is a polarizer layer (not a protective film) on the surface of the screen. Do not peel it off, or the product may be damaged and the warranty will be invalid.

Packing list

- Please check that the package of the monitor contains all parts. If any part is lost, please contact the distributor.
- The color and shape of parts may vary with models. Figures in this User Manual are for reference only.
- Wires supplied may vary with purchased products. Figures in this User Manual are for reference only.



Monitor

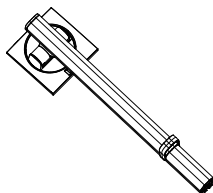

Stand

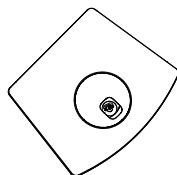

Base



Screw x1pcs

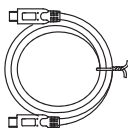

USB-B Cable

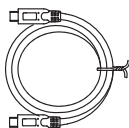

TYPE-C Signal Cable



DP cable

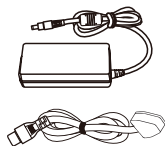

Power adapter x1



after-sales service card

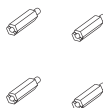

Wall-mounted screws*4



Instructions

- Redundant screws can be used as spare screws.

Installation of base

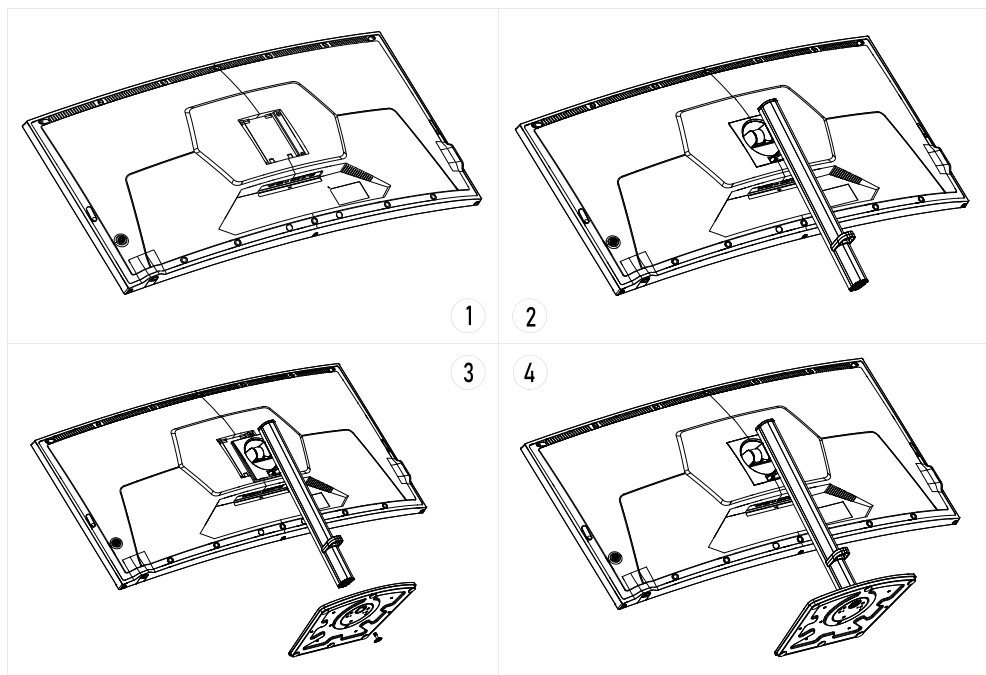

Simply hold the stand with hand to stand the monitor upright.

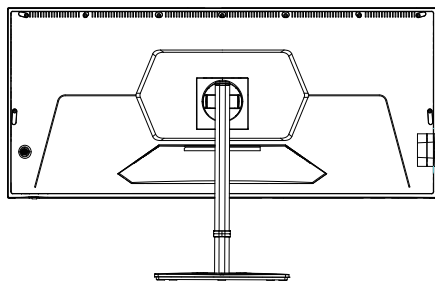
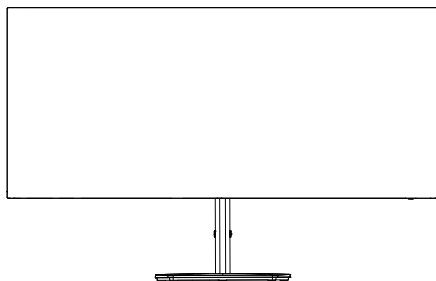

⚠ Note: During standing of the whole monitor, do not press the liquid crystal screen with hand to avoid damage to the screen.

- 1.Place a clean, dry and lint-free cloth on a flat, stable surface.
- 2.Gently lay the monitor on the cloth with the screen facing down.
- 3.Identify the four wall mounting screw holes on the back of the monitor.
- 4.Install the wall mounting bracket (not provided) on the back of the monitor and attach the monitor to the wall according to the mounting bracket's instructions.
- 5.Ensure that all screws (not provided) are tightened and secured.

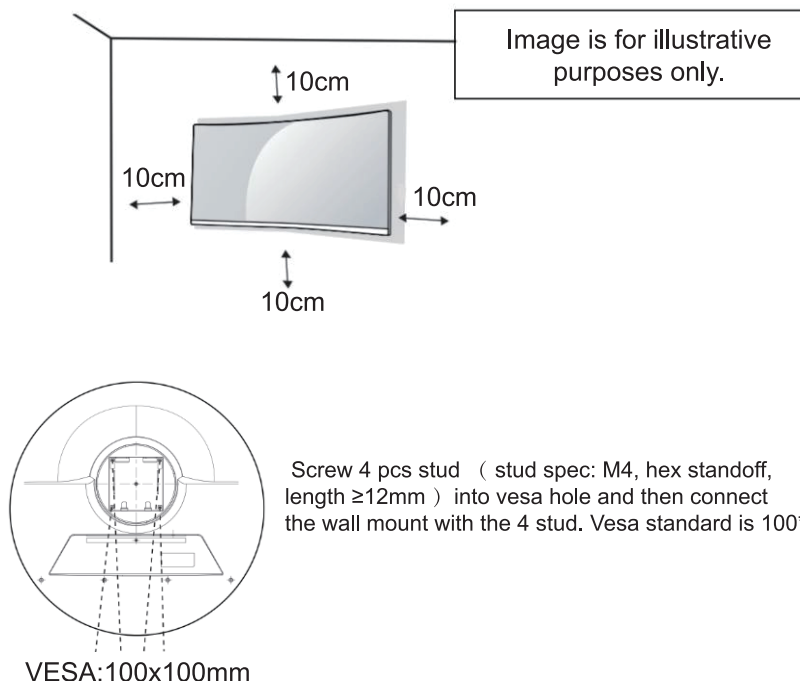

Notes:

- Use a wall mounting bracket and screws that conform to VESA standards. Ensure that the box fits appropriately.
- For more information, please refer to the user manual for the wall mounting bracket.
- This monitor model does support wall mounting, however, due to its size, it is recommended to use a stand.

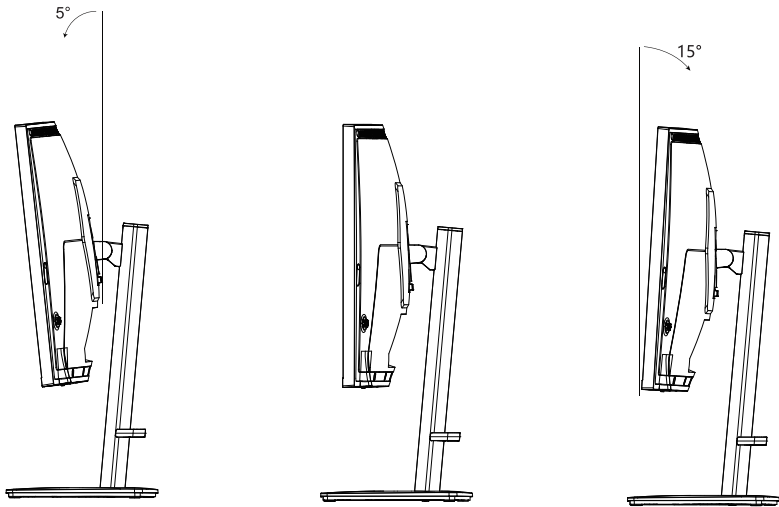

Tilting angle
-5° - +15°

Cable connection:

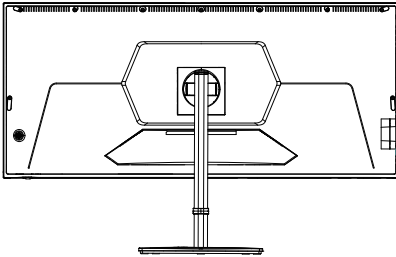

* The bottom interface configuration at the back of the monitor varies with products.

* Note: If the power cable or signal cable is damaged, you must replace it with special soft cables or special components purchased from the manufacturer or maintenance department.

HDMI interface



Use the HDMI cable to connect the HDMI IN interface of the product to the HDMI OUT interface of a PC.



DP interface



Use the DP cable to connect the DP IN interface of the product to the DP OUT interface of a PC.



AUDIO OUT

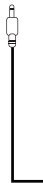

Connect audio outputting devices such as earphones to the AUDIO OUT interface.



Power Adapter



Please connect the power adapter to the power adapter interface of a PC, and plug the other end of the power cable into the power socket.



TYPE-C



Type-C



Connect the monitor to your mobile device or laptop using a USB-C cable.



USB



USB

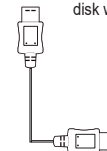

Use the USB-B cable or Type-C cable to connect with your PC and the monitor, then you can connect the keyboard/ mouse/ disk with monitor's USB-A port.



Description of buttons

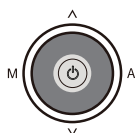

Multifunctional button with 5 functions

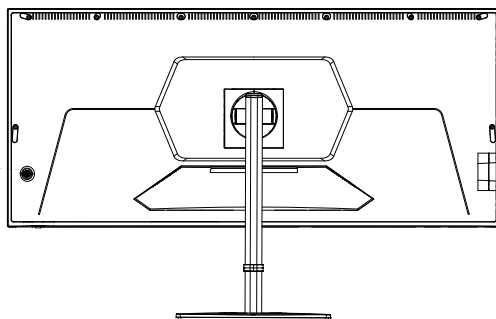

Usage of multifunctional button control key

▲	Plus key	Move the selection upwards / Increase the value (Also as FPS mode hotkey)
▼	Reduce key	Move the selection downwards / Reduce the value(Also as adjust signal key)
↶	Exit key	Return to the previous level menu or exit the OSD menu(Also as Game Crosshair hotkey)
↷	Menu	Pop up the menu, or confirm the selection
⏻	Power Button	Press the pop-up menu lightly and hold it for 2 seconds to turn off the display

Menu description

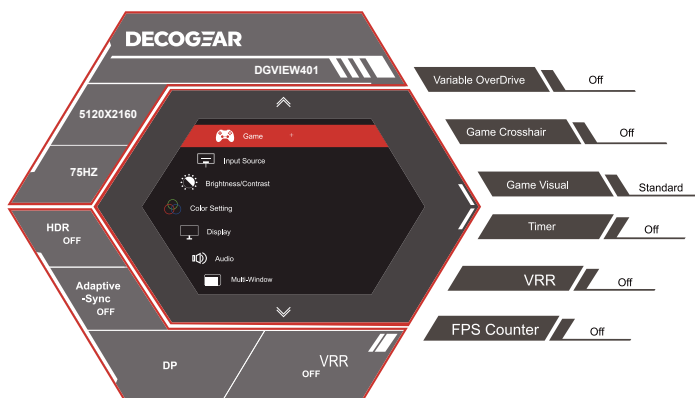

Display PBP/PIP function

Multi-source support:

At least 2 video resources(such as HDMI and DP) must be connected to the PC computer and the display respectively.

Enable the PIP/BBP feature

- 1.Press "M" button to pop out the OSD menu.
- 2.Select "Multi-Window" in the menu, to set PIP or PBP mode.

Adjust the split-screen setting

- 1.PIP Size settings: Select three sizes: Small, Medium, and Large
- 2.Source Configuration: Select the corresponding input device (e.g. DP1, HDMI) in the "Source" option.
- 3.Select "Top Left", "Top Right", "Bottom Left", "Bottom Right" to change small window position.

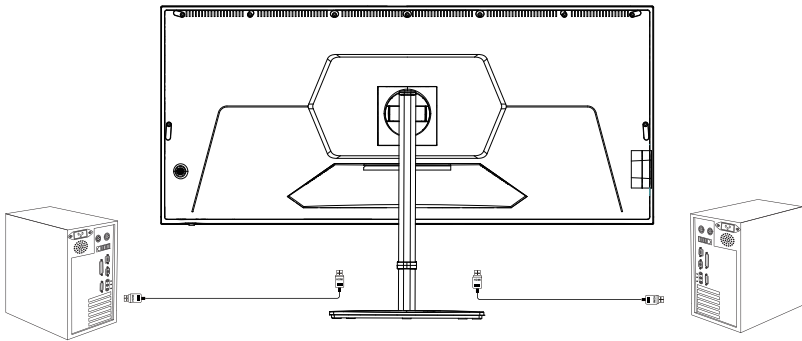

Game+	Variable OverDrive	Off/High/Medium/Low
	Game Crosshair	Off/Mode1/Mode2/Mode3
	Game Visual	Standard/Movie/RTS/RPG/FPS/MOBA/sRGB/Reader
	Timer	Off/30/50/60/90
	Game Light	On/Off
	VRR	On/Off
	FPS Counter	On/Off
	Night Counter	Off/Mode1/Mode2
	Magnifier Mode	Off/On
Input Source	DP/HDMI/Type C	
Brightness/Contrast	Brightness	0-100
	Black Equalizer	0-100
	Contrast	0-100
	DCR	On/Off
	AI light sensor	On/Off
Color Setting	Gamma	1.8/2.0/2.2/2.4/2.6
	Color Temperature	Warm/Normal/cool/USER
	Low Blue Light	0-100
	Hue	0-100
	Saturation	0-100
	Sharpness	0-100
	Color Space	native/sRGB/DCI-P3/Adobe RGB
Display	Aspect Ratio	wide screen/4:3/1:1/Auto
Audio	Mute	On/Off
	Volume	0-100
Multi-Window	Multi-Window	Off/PIP Mode/PBP 2win
	Sub Win 2 Input	DP1/DP2/HDMI1/HDMI2/Type C
	PIP Size	Small/medium/large
	PIP Position	TopRight/TopLeft/BottomRight/BottomLeft
	Swap	
OSD Setting	Language	
	OSD H-Position	0-100
	OSD V-Position	0-100
	OSD Transparency	0-100
	OSD Time Out	5-100
	OSD Rotation	Off/90/180/270
Other	FreeSync	On/Off
	HDR	On/Off
	MPRT	On/Off
	Power Indicator	On/Off
	ECO Mode	On/Off
	Reset	

Product Name	40" 5K Monitor	
Product model	DGVIEW401	
Screen Size	40 inches (101.6cm)	
Aspect Ratio	21:9	
Viewing Angle	178°(H) / 178°(V)	
Panel Type	IPS	
Contrast ratio	1000:1 (TYP)	
Colors	1.07B	
Resolution	5120x2160	
Maximum refresh rate	75Hz	
Power Consumption	DC 24V \approx 6.25A The standard voltage and current may vary with countries, please refer to the label at the back of the product.	
Input	HDMI+DP+TYPE-C(90Watt)+USB+ Hub+Audio out	
Product Dimentions With base	949(W)*602(H)*242(D) mm	
VESA Wall-Mount	100x100mm	
Tilting angle	Forward titling: 5° \pm 2°; Backward tilting: 15° \pm 2°	
Height range	130mm	
Rotation angle	Left 25° Right 25°	
Vertical angle	N/A	
Environmental conditions	Working	Temperature: 0°C~ 40°C (32°F ~ 104°F) Humidity: 10%~90% RH (non-condensing)
	Storage	Temperature: -20°~ 60° (-4°F ~ 140°F) Humidity: 5%~95% RH (non-condensing)



Manufacturer's 1-Year Limited Warranty

The manufacturer warrants that all parts and components are defect free in materials and workmanship for 1 year. This warranty is valid only in accordance with the conditions set forth below:

1. The warranty extends only to the original consumer purchaser and is not transferable. In addition, proof of purchase must be demonstrated.
2. This limited warranty is the only written or express warranty given by the manufacturer. Any implied warranty of merchantability or fitness for a particular purpose on this product is limited in duration to the duration of this warranty. Some states do not allow limitations on how long an implied warranty lasts, so the above limitation may not apply to you.
3. This warranty gives you specific legal rights. You may also have other rights which vary by state

Procedure for Replacement or Return within the 1 Year:

To return the product for replacement or refund within the 1 year, the original purchaser must pack the product securely and send it postage paid with a description of the reason for replacement or refund, proof of purchase, and include your order number on the package, to the following address:

Deco Gear
80 Carter Drive
Edison, NJ 08817

Other contact info

Phone: 844-413-2646

Customer Service Email: customerservice@decogear.com

东莞万联显示科技有限公司

料号：	210-40W5MX-002001		
名称：	说明书		
版本：	V1	日期：	20250818

技术要求：

- 1、100g书写纸
- 2、尺寸：140x210mm；
- 3、彩色印刷，骑马钉；
- 4、不得有缺页，漏印，字迹模糊；
- 4、符合RoHS标准。