

DECOGEAR®

49" DQHD Monitor



DGVIEW401

- Keep the monitor away from water sources or damp places, such as bath rooms, kitchens, basements and swimming pools.
- Make sure the monitor is placed on a flat surface. If the monitor falls down, it may cause human injury or device damage.
- Store and use the monitor in a cool, dry and well ventilated place, and keep it away from emission and heat sources.
- Do not cover or block the vent hole in the rear casing, and do not use the product on a bed, sofa, blanket or similar objects.
- The range of the supply voltage of the monitor is printed on the label on the rear casing. If it is impossible to determine the supply voltage, please consult the distributor or local power company.
- If the monitor will not be used for a long period, please cut off the power supply to avoid electric shock in rainy days and damage due to abnormal supply voltage.
- Please use a reliable earthing socket, do not overload the socket, or it may cause fire or electric shock.
- Do not put foreign matters into the monitor, or it may cause short circuits resulting fire or electric shock.
- Do not disassemble or repair this product by self to avoid electric shock. If faults occur, please contact the after-sales service directly.
- Do not pull or twist the power cable forcibly.
- There is a polarizer layer (not a protective film) on the surface of the screen. Do not peel it off, or the product may be damaged and the warranty will be invalid.

Packing list

- Please check that the package of the monitor contains all parts. If any part is lost, please contact the distributor.
- The color and shape of parts may vary with models. Figures in this User Manual are for reference only.
- Wires supplied may vary with purchased products. Figures in this User Manual are for reference only.



Monitor

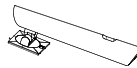

Stand



Decorative
Cover



Base

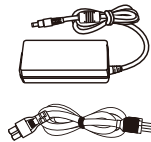

Power adapter x1



Screw x1

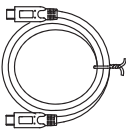

TYPE-C Signal line



DP Signal line



Instructions

- Redundant screws can be used as spare screws.

Installation of base

1. With the monitor on a flat surface, attach the stand by locking into place.
2. Use screws to lock the base to the column and the installation is complete.

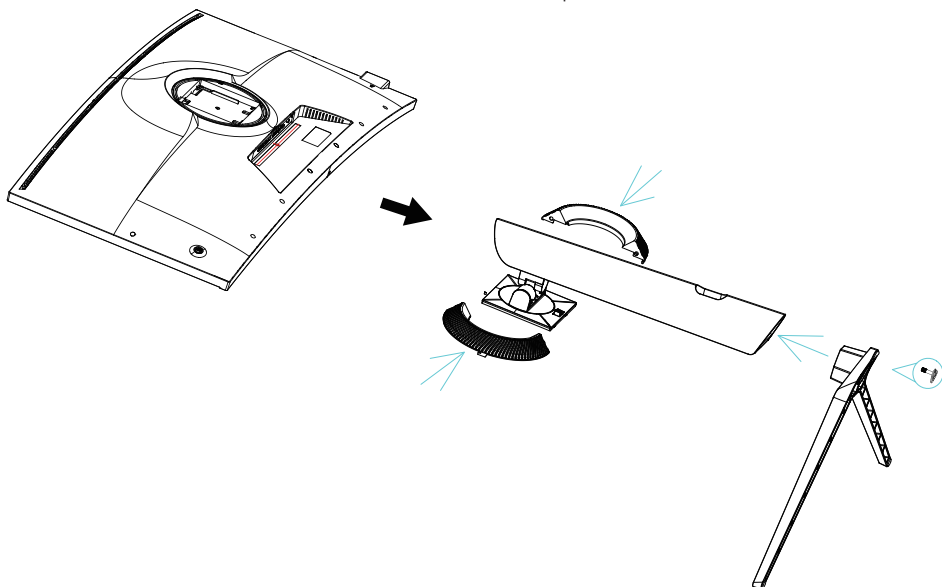

3. After assembly, simply hold the stand to stand the monitor upright.



- ⚠ Note:** During standing of the whole monitor, do not press the liquid crystal screen with your hands to avoid damage to the screen.

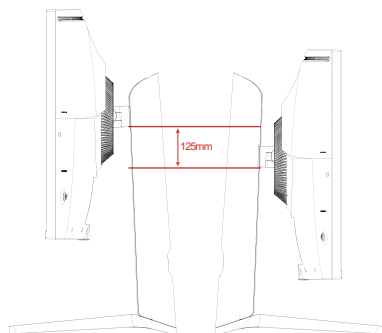

Height Adjustment: $125 \pm 5\text{mm}$

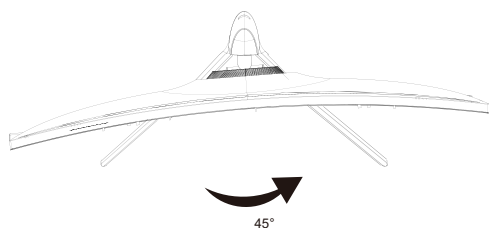
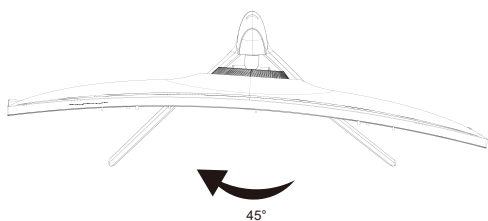

Rotation: Left: $45^\circ (\pm 3^\circ)$; Right: $45^\circ (\pm 3^\circ)$

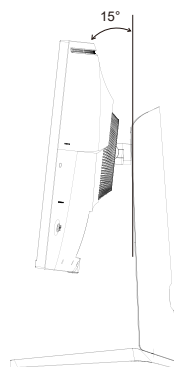
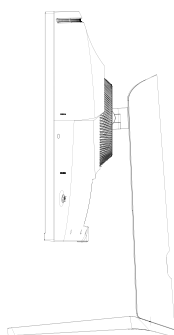
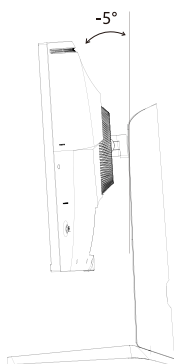

Tilt Angle: $5.0^\circ (\pm 3.0^\circ)$ to $+15^\circ (\pm 3.0^\circ)$

Description of buttons

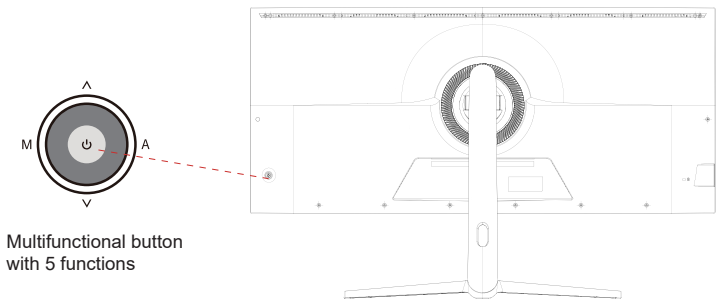

Usage of multifunctional button control key

M	Menu	Activate and confirm the OSD Menu
^	Preset Mode	Select items and adjust parameters upwards in the menu.
v	Signal Switch	Select items and adjust parameters downwards in the menu.
A	Back/Exit	When in the menu, go back or log out / Game Plus Crosshair.
⏻	Power Button	Press once to switch on the power, press and hold for 3 seconds to switch off the power.

Explanation of indicators

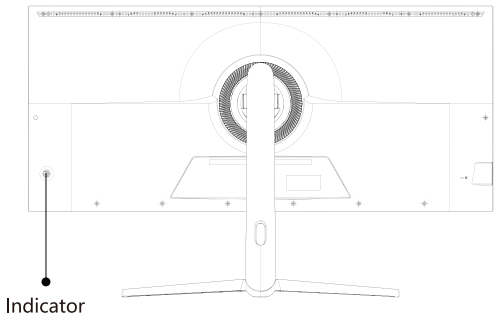

Indicator Lights:

Steady Blue Light: The monitor is powered on and operating normally.

Steady Red Light: No video source detected, or there is no horizontal/vertical signal. This could also indicate low voltage.

Please ensure your computer is turned on, and all video cables are securely connected.

Cable connection:

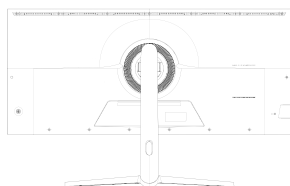

- * The bottom interface configuration at the back of the monitor varies with products.
- * Note: If the power cable or signal cable is damaged, you must replace it with special soft cables or special components purchased from the manufacturer or maintenance department.

HDMI interface

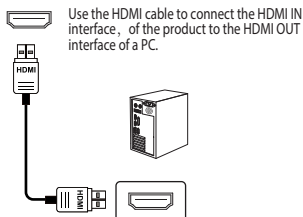

DP interface

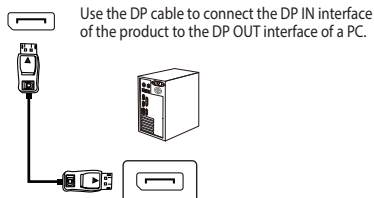

AUDIO OUT

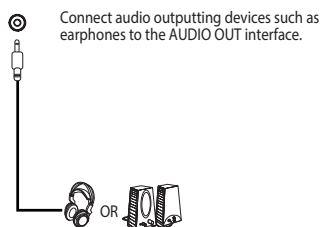

Power Adapter

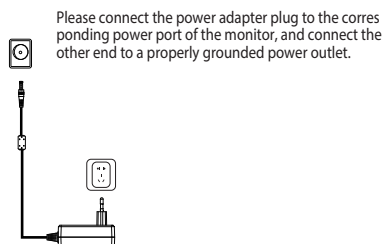

TYPE-C

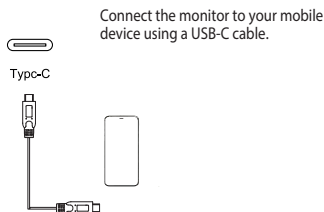

USB

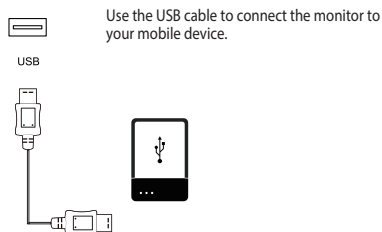

Menu description

The color and shape of the OSD menu of the actual monitor may be slightly different from what is shown in the figure. Specifications of the OSD menu may change with improvements of functions without prior notice.

The screen display (OSD) menu can be used to adjust settings of the monitor and is shown on the screen after the monitor is powered on and the M button is pressed.

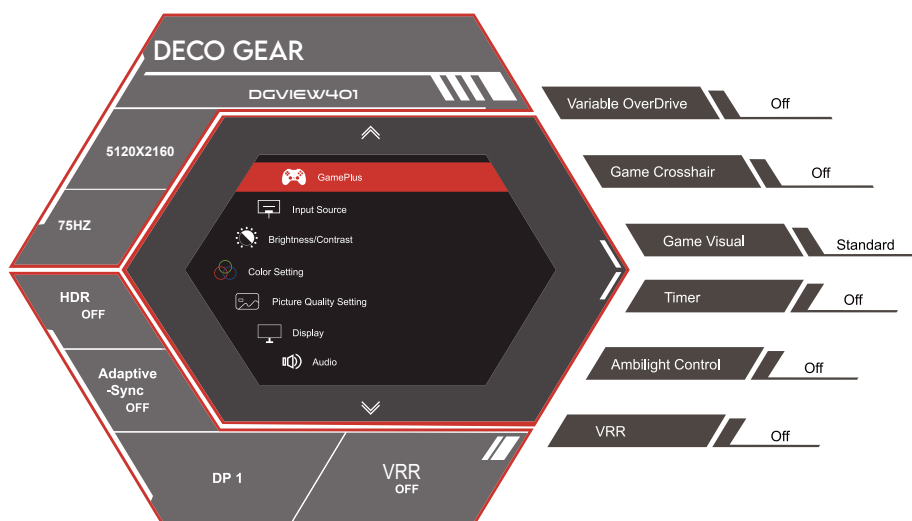

M	Menu	Activate and confirm the OSD Menu
^	Preset Mode	Select items and adjust parameters upwards in the menu.
√	Signal Switch	Select items and adjust parameters downwards in the menu.
A	Back/Exit	When in the menu, go back or log out / Game Plus Crosshair.
⏻	Power Button	Press once to switch on the power, press and hold for 3 seconds to switch off the power.

Product Name		40" DQHD Monitor
Product model		DGVIEW401
Screen Size		40 inches (101.6cm)
Aspect Ratio		21:9
Viewing Angle		178°(H) / 178°(V)
Display Area (H*V)		929.28(H) × 392.04(V) mm
Contrast ratio		1000:1 (TYP)
Colors		1.07B
Resolution		5120x2160
Maximum refresh rate		75Hz
Power specifications		DC 24V \approx 6.25A The standard voltage and current may vary with countries, please refer to the label at the back of the product.
Product Dimentions Normal base	Without base	947(W)*418(H)*122(D) mm
	With base	947(W)*594(H)*306(D) mm
Tilting angle		Forward titling: 5° \pm 2°; Backward tilting: 15° \pm 2°
Height range		125mm
Rotation angle		Left 45° Right 45°
Vertical angle		NA
Environmental conditions	Action	Temperature: 0°C ~ 40°C (32°F ~ 104°F) Humidity: 10%~90% RH (non-condensing)
	Storage	Temperature: -20° ~ 60° (-4°F ~ 140°F) Humidity: 5%~95% RH (non-condensing)



Manufacturer's 1-Year Limited Warranty

The manufacturer warrants that all parts and components are defect free in materials and workmanship for 1 year. This warranty is valid only in accordance with the conditions set forth below:

1. The warranty extends only to the original consumer purchaser and is not transferable. In addition, proof of purchase must be demonstrated.
2. This limited warranty is the only written or express warranty given by the manufacturer. Any implied warranty of merchantability or fitness for a particular purpose on this product is limited in duration to the duration of this warranty. Some states do not allow limitations on how long an implied warranty lasts, so the above limitation may not apply to you.
3. This warranty gives you specific legal rights. You may also have other rights which vary by state

Procedure for Replacement or Return within the 1 Year:

To return the product for replacement or refund within the 1 year, the original purchaser must pack the product securely and send it postage paid with a description of the reason for replacement or refund, proof of purchase, and include your order number on the package, to the following address:

Deco Gear
80 Carter Drive
Edison, NJ 08817

Other contact info

Phone: 844-413-2646

Customer Service Email: customerservice@decogear.com