

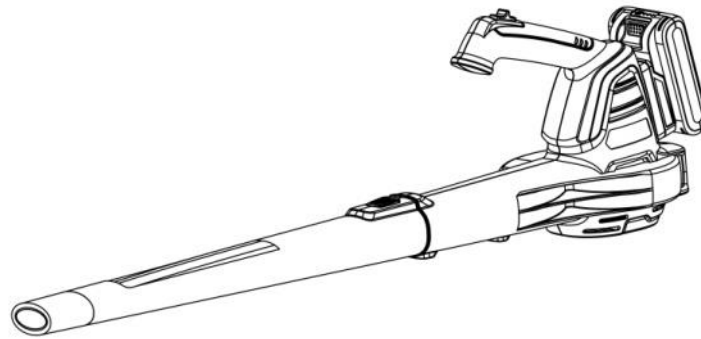

Cordless Electric Leaf Blower

Operation Manual



MODEL NO. DGLB01

Specifications

Model	DGLB01	
Parameter	Air speed	150 MPH
	Air volume	205 CFM
Speed	No-load/load speed	13000±5% rpm
Length	No nozzle	16.5 inch
	Include nozzle	33 inch
Net weight	3 lbs	
Battery	DC 20V/ 4.0Ah	

- The manufacturer reserves the right to change specifications without prior notice.
- Specifications and battery packs may vary from country to country

Important Notes

The symbols used in this manual are shown below. Make sure you understand their meanings before using the leaf blower.



- Take extra care and attention



- Read the instructions



- Keep away from rotating parts



- Pay attention to blown objects



- Keep onlookers away



- Wear eye and ear protection



- Do not expose to damp environment

Usage

This tool is used to blow off dust, leaves, snow, etc. It's perfect for removing fallen leaves in the autumn and is a great replacement for raking by hand. Additionally, it excels at blowing away clipped grass after mowing the lawn, dust and minor debris from working areas, and more!

Safety Warnings for the Leaf Blower

1. When using the blower, please be sure to wear goggles, protective cap, and face mask.
2. When using the blower, do not point the nozzle at anyone in the working area.

3. Warning: if used on wet surfaces, it may cause electric shock. Keep this tool out of the rain. Store indoors.

4. Do not block the inlet or outlet

- Do not clog the air inlet or air outlet when cleaning dusty areas.
Do not use conical nozzles smaller than the original nozzles - such as new nozzles connected to the nozzle end through additional small diameter hoses installed or smaller hoses.

- Do not use for inflating balloons, kayaks, or similar inflatable items.

Increasing the motor's speed could cause the fan to break, causing serious personal injury. Overheating of the motor and control circuitry could cause fire.

5. Keep children, other bystanders and pets away from the blower during operation.

6. Do not operate the leaf blower near an open window, etc.

7. It is recommended to operate the blower at a suitable time such as morning or afternoon to avoid disturbing the residents

8. It is recommended to use a rake and a broom to separate the pieces before blowing

9. When using a blower in dusty environment, it is recommended to use a commercially available mist remover to slightly moisten the dusty surface.

10. A long nozzle is recommended to bring the flow closer to the ground.

11. Young children or unsupervised frail persons should not be allowed to use air blowers

12. Young children should be kept out of the blower.

:  **WARNING**

Do not become too familiar with the product (experience gained from repeated use) to not strictly follow the relevant product safety rules. Improper use or failure to follow the safety rules in the instructions can result in serious personal injury. Always take the needed precautions and maintain situational awareness of your actions.

BATTERY WARNINGS

1. Before using a battery pack, carefully read all instructions and the warning labels on the battery charger, the battery, and the product using the battery.

2. Do not disassemble the battery pack.

3. If the running time of the machine becomes too short, stop using it immediately. Otherwise it may overheat, catch fire, or even explode.

4. If battery acid enters your eyes flush it with clean water and seek medical attention immediately, otherwise it may cause visual impairment.

5. Do not short-circuit the battery pack:

- (1) Do not allow any conductive material to touch the terminal.
- (2) Avoid placing the battery pack in the same container as other metal objects such as nails or coins, etc.
- (3) Do not leave the battery pack in water or in the rain.

A short circuit in the battery will generate a large current, causing overheating and possibly causing a fire or even a breakdown.

6. Do not place tools and batteries where the temperature may reach or exceed 122 °F.

7. Do not burn the batteries even if they are badly damaged or completely worn out - they could explode in fire.
8. Please be careful not to hit the battery or drop it.
9. Do not use damaged batteries.

Tips for maintaining maximum battery life

1. If you find the leaf blower is low in power, stop the operation of the tool and charge the battery pack.
2. Do not recharge the fully charged battery pack .Overcharging will shorten the life of the battery.
3. Please charge the battery pack at room temperature of 50 ° F-104 °F.

Please charge the hot battery pack only after it cools.

FUNCTION

⚠ NOTICE:

- Before adjusting or checking the function of the tool, be sure to turn off the power of the tool and remove the battery pack.

The installation or removal of a battery pack

⚠ NOTICE:

- Hold the leaf blower and battery when installing or removing the battery pack. Failing to hold the tool and battery pack tightly may cause them to slip out of your hand, damaging the tool and battery pack, and causing personal injury.

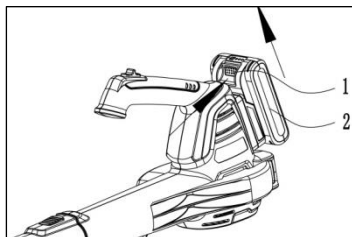

1. Button
2. Battery

- Always turn off the power to the leaf blower before inserting or removing the battery pack.
- To remove the battery pack, press the battery pack button while pulling the battery pack out of the blower
- When inserting a battery pack, align the grooves in the outer cover of the tongue spring on the battery pack, then slide into place, inserting it fully into place until the battery pack is locked and clatters. If no clicking sound is heard after insertion, the battery adapter is not fully locked.
- Do not use brute force when inserting a battery pack. If the battery pack is hard to insert, it may be improperly inserted.

SWITCH OPERATION

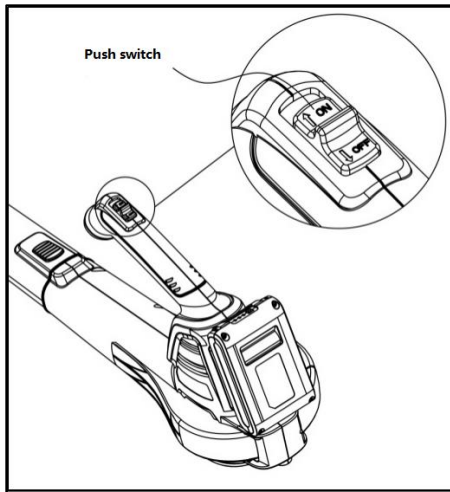

- To start the tool, just push the push-pull switch forward.
- To turn off the tool, just push the pull switch back.

ASSEMBLY

⚠ Notice:

Before performing any assembly operation on the tool, be sure to turn off the tool power and remove the battery pack.

Installation and removal of air duct

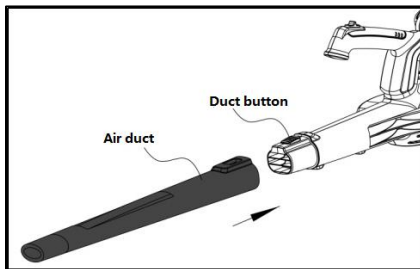

As shown in the figure above, to install the air duct put it into the air outlet of the machine according to the arrow direction in the figure, and ensure that the air duct button fully hooks the air duct.

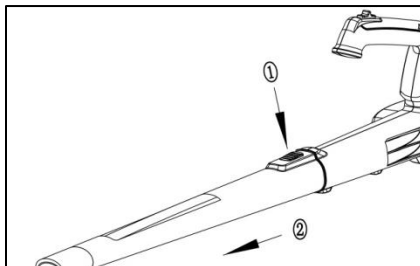

As shown in the figure above, to remove the air duct press the air duct button in the order of arrows in the figure, and then follow the arrow direction seen at step 2 to remove the air duct.

OPERATION

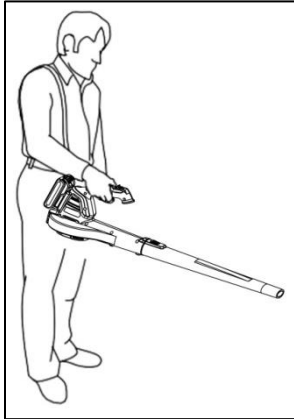

1. Hold the machine with one hand and move slowly to perform the blowing operation. Slowly sway the blow from side to side as you blow material in front of you, moving forward as the material moves.
2. When cleaning around rocks, vehicles, or buildings, do not point the nozzle directly at them. Failure to do so could cause damage via blown debris (scratching a car's paint, blowing debris into an open window of a car or house). Additionally, the debris can be blown back in your direction if in close proximity, causing injury to yourself or others.

When using the leaf blower around objects like these, it's best to position yourself at an angle so the air from the blower is glancing the side of the object or building and away from you.

3. Take care when blowing into a corner position as debris and dust can be blown right back to your position, causing injury. As in step to, take note of your positioning and where the blown air can deflect and escape. Ensure that you are not in the path of the blowback.



Manufacturer's 1-Year Limited Warranty

The manufacturer warrants that all parts and components are defect free in materials and workmanship for 1 year. This warranty is valid only in accordance with the conditions set forth below:

1. The warranty extends only to the original consumer purchaser and is not transferable. In addition, proof of purchase must be demonstrated.
2. This limited warranty is the only written or express warranty given by the manufacturer. Any implied warranty of merchantability or fitness for a particular purpose on this product is limited in duration to the duration of this warranty. Some states do not allow limitations on how long an implied warranty lasts, so the above limitation may not apply to you.
3. This warranty gives you specific legal rights. You may also have other rights which vary by state

Procedure for Replacement or Return within the 1 Year:

To return the product for replacement or refund within the 1 year, the original purchaser must pack the product securely and send it postage paid with a description of the reason for replacement or refund, proof of purchase, and include your order number on the package, to the following address:

Deco Home
80 Carter Drive
Edison, NJ 08817

Other contact info

Phone: 844-413-2646

Customer Service Email: customerservice@decogear.com